

# CleanGo

Filtering extraction mobile unit for welding fumes

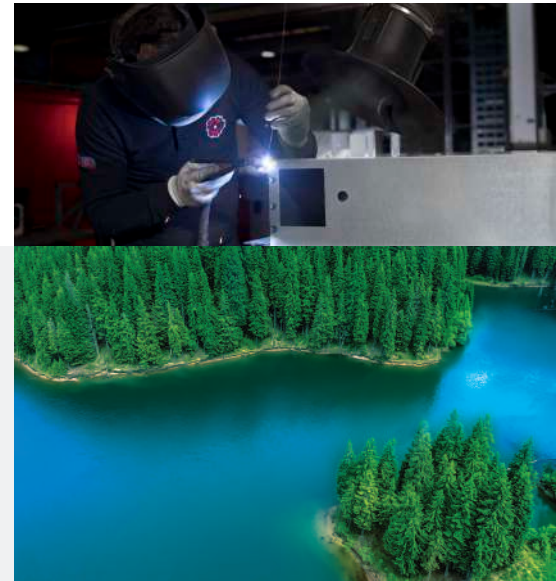

## CleanGo

- CleanGo
- CleanGo **W3**
- CleanGo **Wall**
- CleanGo **Bench**



Innovative Air Solutions  
For a cleaner future.

# Design

The CleanGO range of mobile extractors offers ultra-compact and highly manoeuvrable filters, ideal for occasional use in environments with low concentrations of welding fumes, typical of machining operations in the mechanical industry. It is supplied complete of extraction arm from our Dynaflex range.

CleanGo

4 Models

## Highlights

- Our standard carted unit is equipped with 2 or 3 metres Dynaflex flexible arm.
- **Extremely easy to position it.**
- Highly precise filter monitoring by hour meter.
- Plug & Play' solution, no installation required.

## Applications



Welding fumes

## Soluzioni per l'aria pulita



The powerful suction ensures effective extraction of harmful welding fumes, while preventing the suction of technical gases and the cooling of welds, thus preventing dangerous metal shrinkage. The CleanGo Wall filter unit, as a wall-mounted version, is connected to an extension and a Dynaflex extraction arm. This system is designed to be used in working environments.

# Filtration technology



IFA-BGIA: Institute for Working Safety and Health (Bonn - Germany)  
 AGW: Working Exposure Limit Value (Arbeitsplatzgrenzwerte)

### DESCRIPTION AND PURPOSE

The purpose of the IFA-BGIA institute is to ensure the safety of workers in the workplace. Filter materials are analysed by establishing the use of classes L, M, H. BIA has also established an exposure limit value (AGW) above which worker safety is no longer guaranteed. The exposure limit value to a pollutant is the concentration in the air that a person can breathe during a limited period of 15 minutes without immediate toxic effects. The IFA-BGIA test is carried out using the following parameters:

- Passage velocity of 0.056 m/s
- Quartz dust concentration  $200 \pm 20 \text{ mg/m}^3$
- Variable particle size between 0.2 and 2 microns

| CLASS OF USE | CONCENTRATION  | MAXIMUM AUTHORISED RELEASE |
|--------------|--|----------------------------|
| M            | Filtering out dust with AGW values $\geq 0,1 \text{ mg/m}^3$ | >99,9%                     |

## maintenance

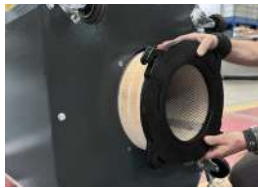

CleanGo and CleanGo Bench Version

CleanGo W3 Version

Maintenance of the machine is limited to the replacement of filters, an operation that requires a short time and non-specialised staff

## Filter Media

| MEDIA   | MATERIALS   | m <sup>2</sup> | g/m <sup>2</sup> | STANDARD | OPTIONAL |
|---|---|----------------|------------------|----------|----------|
| M-CEL   | CELLULOSE 6066  | 12             | 213              | ■        |          |
| M PES/ FR   | POLIESTERE/ FIAMMA RITARDANTE                                       | 7              | 270              |          | ■        |
| M-PES+PTFE/Membrane-H   | POLYESTER/TEFLON MEMBRANE/<br>FABRIC WITH H13 FILTRATION EFFICIENCY | 12             | 270              |          | ■        |
| Cartridges wiith activated charcoal to be inserted to the cellulose cartridges M-CEL                            |   |                | 2,5 Kg           |          | ■        |
| Cartridge with activated carbon and polyester prefilter COL 500A to be inserted in place of the M CEL cartridge |   |                | 10 Kg            |          | ■        |

STANDARD  
CleanGo | W3 | Wall | Bench



M CEL

OPTIONAL  
CleanGo | W3 | Wall | Bench



M-PES/FR  
M-PES+PTFE/Membrane-H

OPTIONAL  
CleanGo | W3 | Wall | Bench



2,5 KG activated carbons to be inserted in the cellulose cartridge

OPTIONAL  
CleanGo | W3 | Wall | Bench



Activated carbon cartridge to be inserted in place of the cellulose cartridge.  
Carbon weight: 10 kgs

# Principle of operation

The polluted air, extracted by the fully articulated, extendable, 360° rotating, arm, is conveyed into the settling chamber, where the heavier particles are deposited. At the same time, the finer particles hanging in the air are captured and retained by the high-efficiency filter and, as a final step (optional), purified through activated charcoal filters. The latter help to reduce the smell of the fumes. At the end of the process, the purified air is returned to the environment from the lower part of the machine. In the CleanGo Banco system, the air is extracted through the worktop and front wall and it is pulled downwards. From there, it is conveyed inside the machine body. The air containing fumes is filtered by the high-efficiency filter, which retains the particles, while the purified air is released from the lower part of the machine.

## CleanGo



- ① Fumes air inlet
- ② Fan
- ③ Filter cartridges
- ④ Filtered air outlet
- ⑤ Hour counter  
Run/stop switch
- ⑥ Pentapolar socket

## CleanGo W3

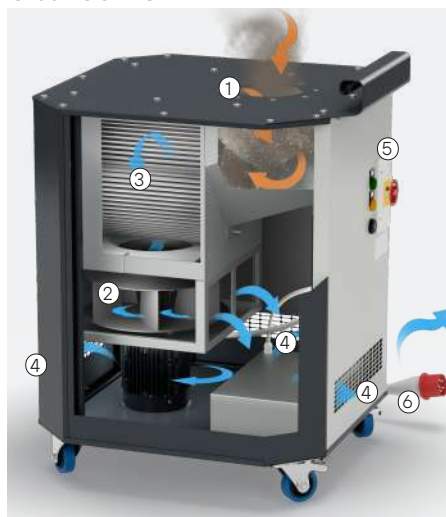

## CleanGo Wall



## CleanGo Bench

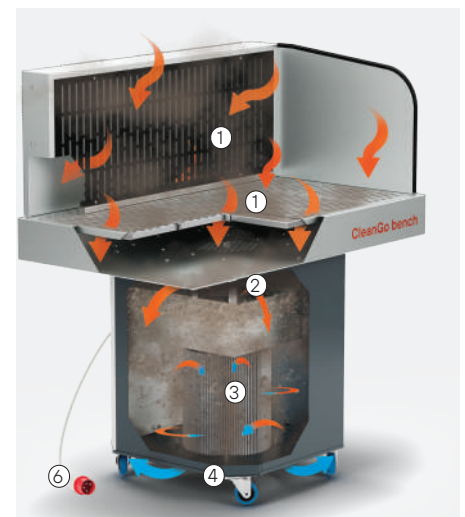

# Production range



## CleanGo

Carted filtering unit for welding fumes, equipped with a Dynaflex arm or as an optional with our Evolution No Smoke suction. It is compact, manoeuvrable and robust.

| Cartridges (nr) | Power (kW) |
|-----------------|------------|
| 1               | 1,1        |



## CleanGo W3

Filter cartridge unit for welding fumes containing CMR (carcinogenic mutagenic reprotoxic substances) made of high-alloy steel with a nickel and chromium content >5% and fulfils requirements of class W3 regulated by UNI EN ISO 21904-1. Equipped with a Dynaflex suction arm.

| Cartridges (nr) | Power (kW) |
|-----------------|------------|
| 1               | 1,1        |



## CleanGo Wall

Wall-mounted filter unit, equipped with a Dynaflex arm or as an optional with our Evolution No Smoke suction arm. It is compact, handy and sturdy.

| Cartridges (nr) | Power (kW) |
|-----------------|------------|
| 1               | 1,1        |



## CleanGo Bench

A carted unit with suction and filtering bench, designed to extract and filter welding fumes during occasional mechanical work. It is compact, durable and easy to use.

| Cartridges (nr) | Power (kW) |
|-----------------|------------|
| 1               | 1,1        |

# Technical features

| Technical features            |                   | Model CleanGo |          |          |               |
|-------------------------------|-------------------|---------------|----------|----------|---------------|
|                               |                   | CleanGo       | W3       | Wall     | CleanGo Bench |
| Power                         | kW                | 1,1           | 1,1      | 1,1      | 1,1           |
| Nominal air flow              | m³/h              | 1400          | 1300     | 1400     | 850           |
| Air flow capacity at arm Ø160 | m³/h              | 1000          | 1100     | 1000     |               |
| Number of Arms Dynaflex       | mm<br>3 mt        | 1 x Ø160      | 1 x Ø160 | 1 x Ø160 | 1 x Ø160      |
| Number of cartridges          | Ø325mm<br>H 400mm | 1             | 1        | 1        | 1             |
| Filtering Surface             | m²                | 12            | 12       | 12       | 12            |
| Cartridge classification      |                   | CELLULOSE     |          |          |               |
| R.P.M.                        |                   | 2846          | 2846     | 2846     | 2846          |
| STD power supply              | V                 | 230/400       | 230/400  | 230/400  | 230/400       |
|                               | Hz                | 50            | 50       | 50       | 50            |
| Noise level                   | dB                | 72            | 73       | 72       | 73            |
| Total weight                  | kg                | 80            | 80       | 80       | 80            |

# Standard Components

CleanGo | W3 | Wall



Dynaflex suction arm 3 m ø160

CleanGo | W3 | Bench

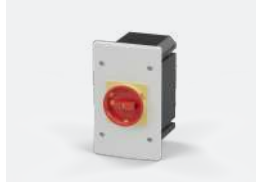

ON/OFF switch

CleanGo | Bench



Hour counter

CleanGo Wall



ON/OFF switch and hour meter

# Options

CleanGo | W3 | Wall



Evolution NO Smoke 3 mt ø160

CleanGo | Wall



Differential pressure gauge

# Overall dimensions

## CleanGo

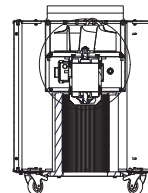
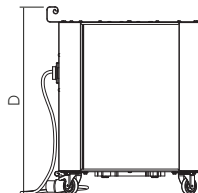
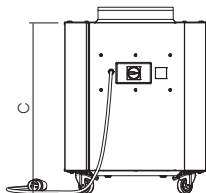
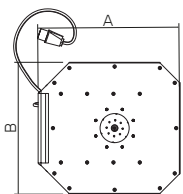

## CleanGo W3

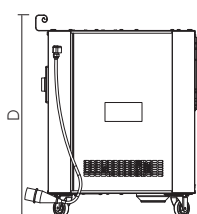
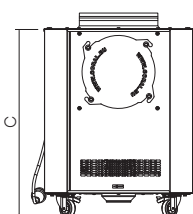
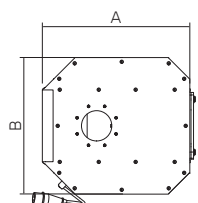

# Overall dimensions

## CleanGo Wall

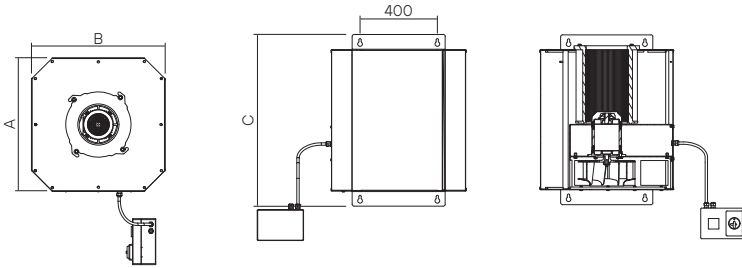

## CleanGo Bench

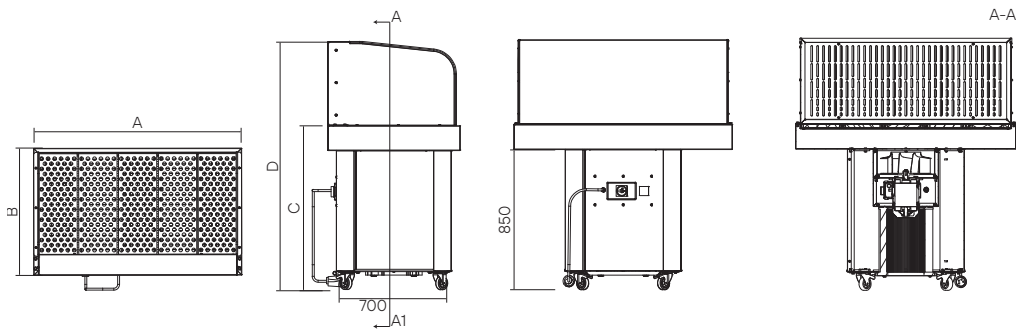

| MODEL                | DIMENSIONS (mm) |     |     |      |
|----------------------|-----------------|-----|-----|------|
|                      | A               | B   | C   | D    |
| CleanGo              | 760             | 700 | 843 | 916  |
| CleanGo <b>W3</b>    | 777             | 700 | 883 | 955  |
| CleanGo <b>Wall</b>  | 700             | 700 | 812 | -    |
| CleanGo <b>Bench</b> | 1305            | 800 | 992 | 1500 |

## Packaging information



| MODEL                | DIMENSIONS (mm) AxBxH              | WEIGHT (kg) |
|----------------------|------------------------------------|-------------|
| CleanGo              | 750 x 850 x 1050                   | 90          |
| CleanGo <b>W3</b>    | 750 x 800 x 1250                   | 95          |
| CleanGo <b>Wall</b>  | 800 x 800 x 1000                   | 90          |
| CleanGo <b>Bench</b> | 1400 x 950 x 1650                  | 170         |
| Dynaflex arm + hood  | 200 x 200 x 1350 + 350 x 400 x 400 | 14,50       |
| Evolution arm + hood | 350 x 580 x 1650 + 350 x 400 x 400 | 40          |

All images and values on this catalogue are indicative and can be subject to modification and improvements. CORAL reserves the right to change them without previous advice.

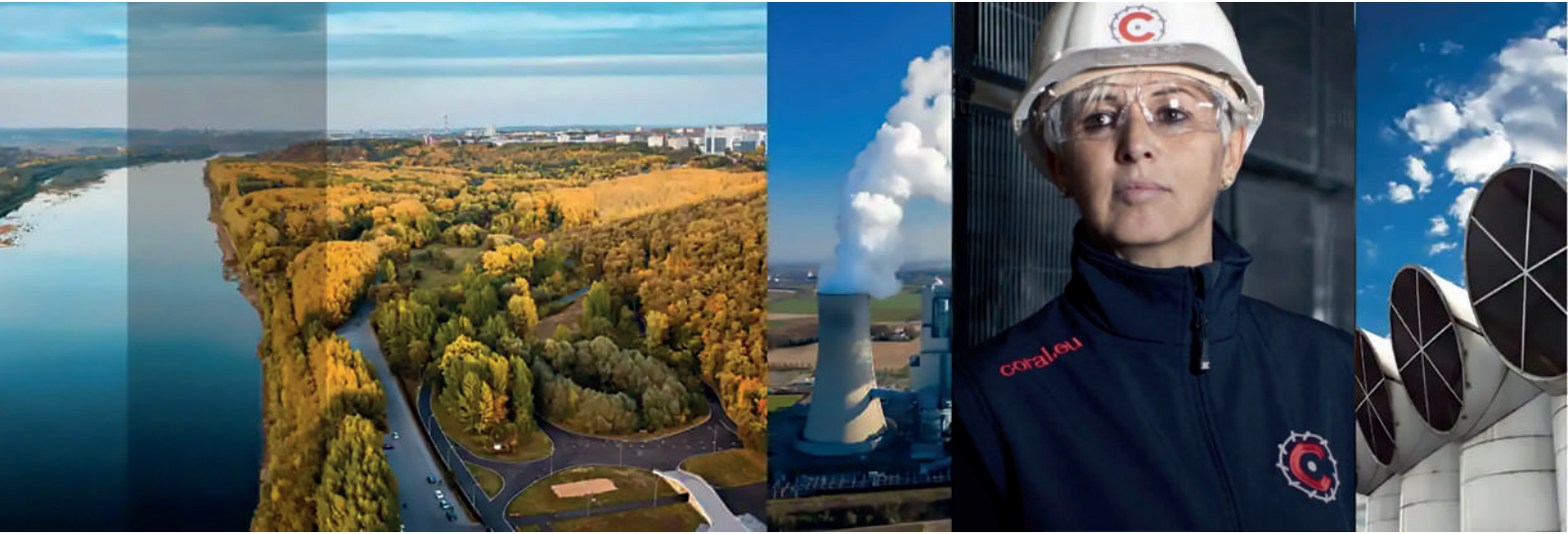

# Made in Coral

Coral manufactures 100% of all the components that are part of an industrial extraction system within their facilities in Volpiano, just outside of Turin. The quality of materials that we use and our industry experience guarantee a production of high level in everything we make.

## ITALIA

|         |                       |
|---------|-----------------------|
| MILANO  | p.: +39 02 9530.1003  |
| TORINO  | p.: +39 011 99.80.141 |
| VICENZA | p.: +39 0444 34.93.98 |
| BOLOGNA | p.: +39 051 69.26.335 |

## FRANCE

|          |                      |
|----------|----------------------|
| LYON     | p.: +33 4 74 944 562 |
| PARIS    | p.: +33 1 60 868 069 |
| POITIERS | p.: +33 5 49 379 596 |

## GERMANY

|            |                        |
|------------|------------------------|
| LEVERKUSEN | p.: +49 214 312 663 20 |
|------------|------------------------|

## UNITED KINGDOM

|                        |                     |
|------------------------|---------------------|
| LITTLEBOROUGH ROCHDALE | p.: +44 1706 377344 |
|------------------------|---------------------|

## MIDDLE EAST

|           |                     |
|-----------|---------------------|
| DUBAI UAE | p.: +971 56 1028130 |
|-----------|---------------------|

## INDIA

|           |                             |
|-----------|-----------------------------|
| BANGALORE | p.: +91 734 888 2333 - 2777 |
|-----------|-----------------------------|

## SINGAPORE

|           |                  |
|-----------|------------------|
| SINGAPORE | p.: +65 88338991 |
|-----------|------------------|

## U.S.A.

|          |                     |
|----------|---------------------|
| KYLE, TX | p.: +1 480 796 5352 |
|----------|---------------------|



**CORAL s.p.a.**

Corso Europa, 597 10088

Volpiano (Torino) ITALY

p.: +39 011 98.22.000

e.: info@coral.eu

**coral.eu**



For a cleaner future